

	~30	~50	~120	~200	~300	~500	~1,000	1,001~
MACHINING	±0.05	±0.1		±0.2				
ASSEMBLY	±0.2	±0.3		±0.4				
ANGLE	±1'		±0'30'	±0'20'				
CABLE(Bending)	±1'	±2	±3	±4	±5	±6		
CABLE(Flexible)	0~+5		0~+10			0~L*0.01		

No.	Revision	Date	Name
△			
△			

RoHS Compliant

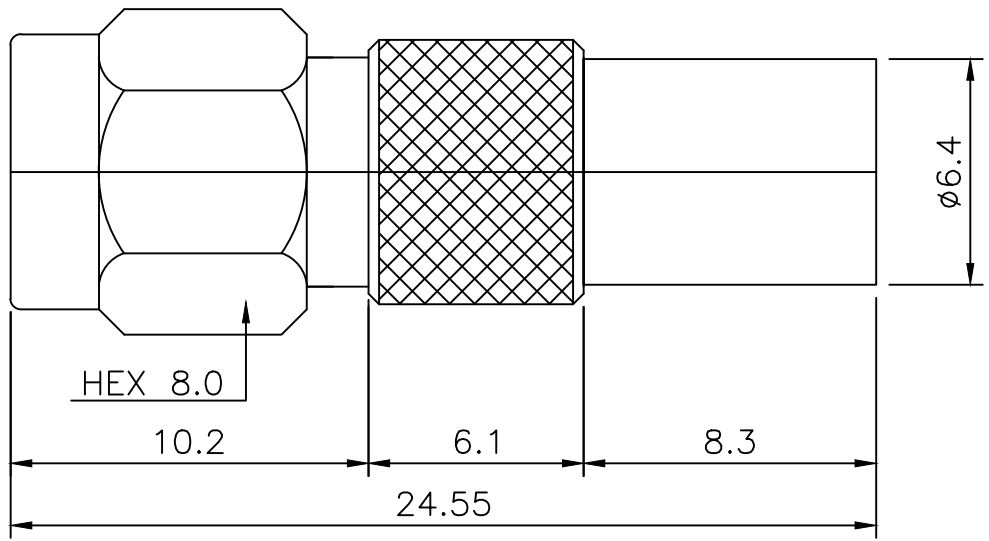

SMA Male to SMB Female ADAPTOR

Item	Materials	Plating
Body	Brass	Nickel Plated
Center contact	Be-Cu	Gold Plated
Insulator	PTFE	-

NO.	DESCRIPTION	Q'TY	MATERIAL	FINISH	REMARKS.
PARTS No.	AD-1415-203	NAME	SMAM-SMBQF-ADAP		APPROVED K.Y.SON
MATERIAL	FINISH				CHECKED
CUSTOMER		SCALE	UNIT mm		DESIGNED M.K.KIM
		DWG NO.	AD-1415-203		DATE. 27/MAR/2015