

4	No.	Revision	Date	Name
	△	PN Change from 1S-1221-001	18/FEB/2014	S.J.PARK
	△			

RoHS Compliant

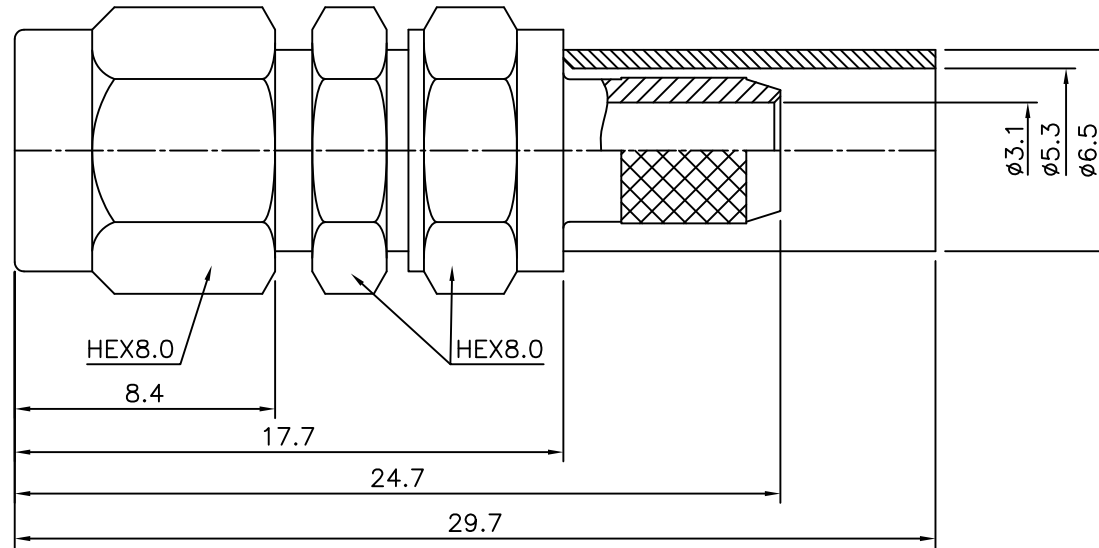

SMA-Straight-PLUG
for Cable:RG58/U,141,303
(Captivated Contact)

Connector parts	Materials	Finish
Coupling Cap	Brass	Gold Plated
Body,Coupling Nut	Brass	Gold Plated
Center contact	Brass	Gold Plated
Ferrule	Brass	Gold Plated
Insulator	PTFE	-

NO.	DESCRIPTION	Q'TY	MATERIAL	FINISH	REMARKS.
PARTS No.	SMA-112-030		NAME	SMA-SP-RG58	APPROVED S.J.LEE
MATERIAL	FINISH	TOLERANCES OTHERWISE SPEC. ± 0.05		ANGLES $\pm 1^\circ$	CHECKED
SCALE		UNIT	DESIGNED		S.J.PARK
N/S		mm	DATE.		
DWG NO.		SMA-112-030		18/FEB/2014	

CUSTOMER



DONGJIN TI.