

1	2	3	4	5	6
RoHS Compliant			No.	Revision	Date
			△		
			△		

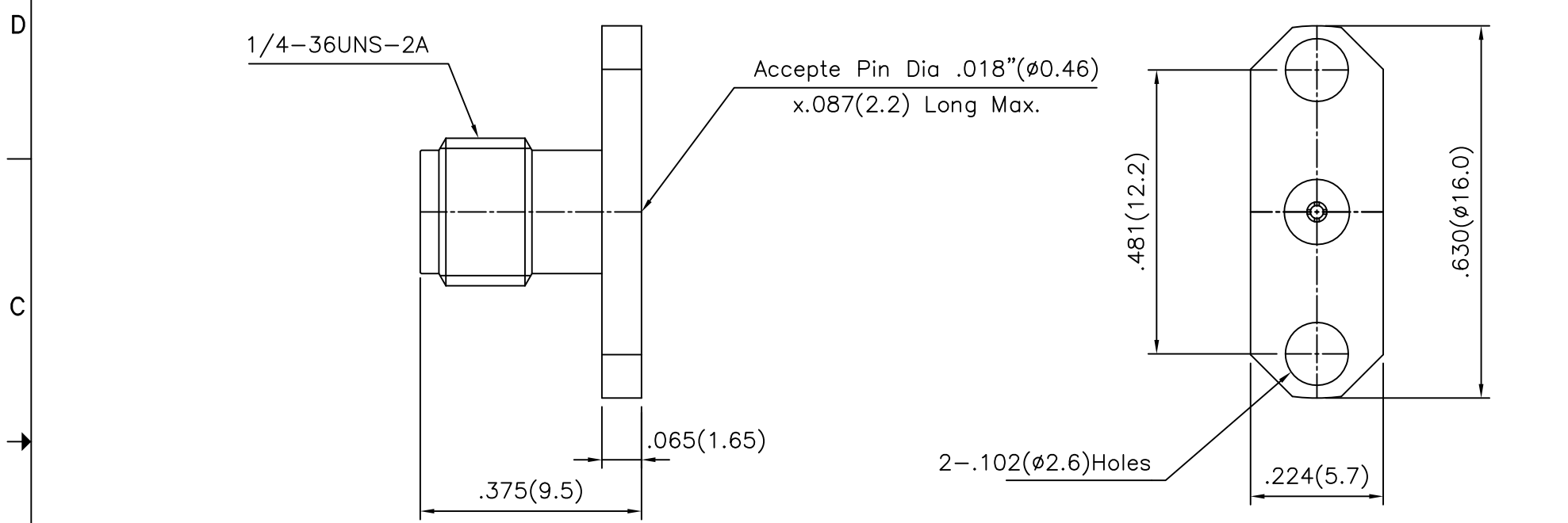

Connector parts	Materials	Finish
Body	Stainless steel	Passivated
Center contact	Beryllium copper	Gold plated
Insulator	PTFE	-

SMA-FEMALE-2Hole Panel (.018" PIN)
Field Replaceable.

SPECIFICATIONS;
 IMPEDANCE : 50 Ohms
 Frequency Range : DC~20 GHz
 Directic Withstanding Voltage : 750 VRMS
 Insulation Resistance : 5000 meghms
 Temperture Range : -55~125°C
 VSWR : 1.05+0.01F. F Operating Frequency in GHz

CUSTOMER

NO.	DESCRIPTION	Q'TY	MATERIAL	FINISH	REMARKS.
PARTS No.	SMA-502-158	NAME	SMA-F2H-Recep.		APPROVED
MATERIAL	FINISH	TOLERANCES OTHERWISE SPEC. ±0.05		ANGLES ±1°	CHECKED
		SCALE	UNIT mm		DESIGNED S.J.LEE
		DWG NO.	SMA-502-158		DATE. 19/FEB/2014