

4	5	6	
No.	Revision	Date	Name
△	PN Change from 1S-515S-8440E	23/DEC/2013	S.J.PARK
△			

RoHS Compliant

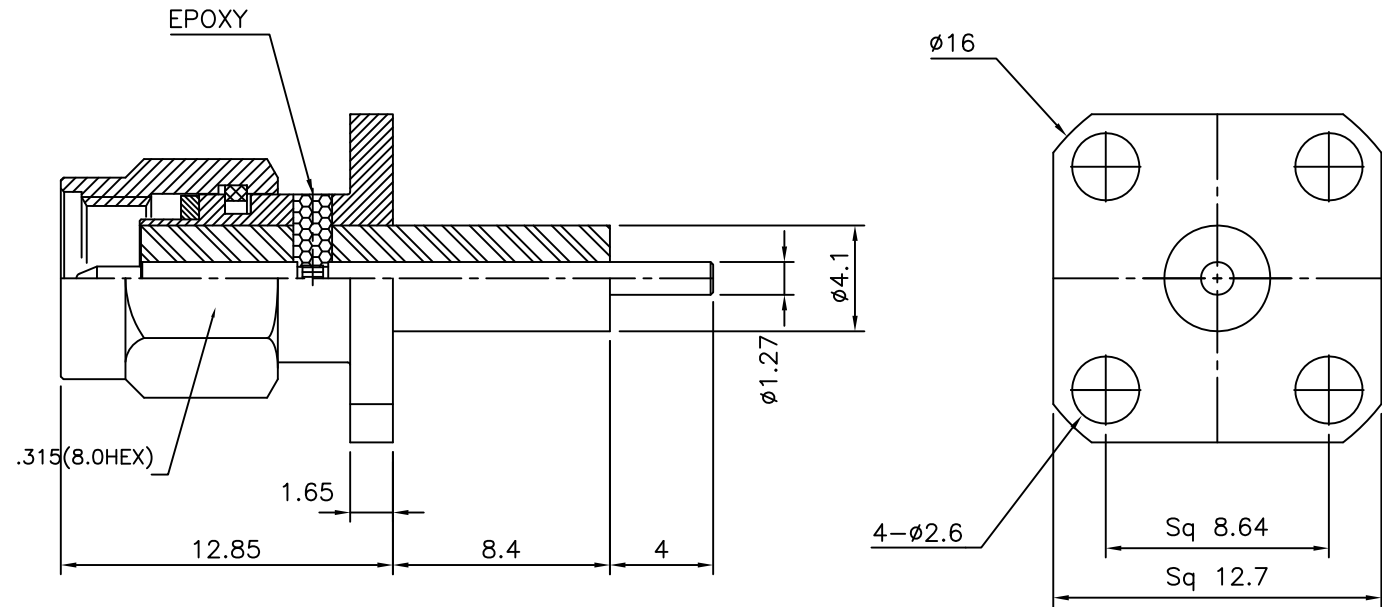

NOTES:

- INTERFACE PER MIL-STD-348
- MATERIALS
INSULATOR: TEFLON
CENTER CONTACT: BRASS
BODY, COUPLING CAP: STAINLESS STEEL 303
- FINISHES
CENTER CONTACT: GOLD PLATE
BODY, COUPLING CAP: PASSIVATED
- CENTER CONTACT TO BE EPOXY CAPTIVATED

SMA-4H PANEL-MALE
COAXIAL END RECEPTACLE

CUSTOMER

NO.	DESCRIPTION	Q'TY	MATERIAL	FINISH	REMARKS.
PARTS No.	SMA-503-004	NAME	SMA-4H-MALE RECEPTACLE		APPROVED
MATERIAL	FINISH	TOLERANCES OTHERWISE SPEC. ±0.05		ANGLES ±1°	CHECKED
		SCALE	UNIT mm		DESIGNED S.J.LEE
		DWG NO.	SMA-503-004		DATE. 20/MAR/2012