

4	5	6
No.	Revision	Date
△	PN Change from 1S-807-00	25/11/2013
△		
		Name
		B.G.YUN

NOTES.

1. Impedance : 50 ohm
2. Frequency range ; Dc to 9.0GHz
3. Return loss : >20dB(1.2:1) DC to 9.0GHz
4. Insulation resistance: 5000 Mohm
5. Average Power handling : 100W in 1GHz

RoHS Compliant

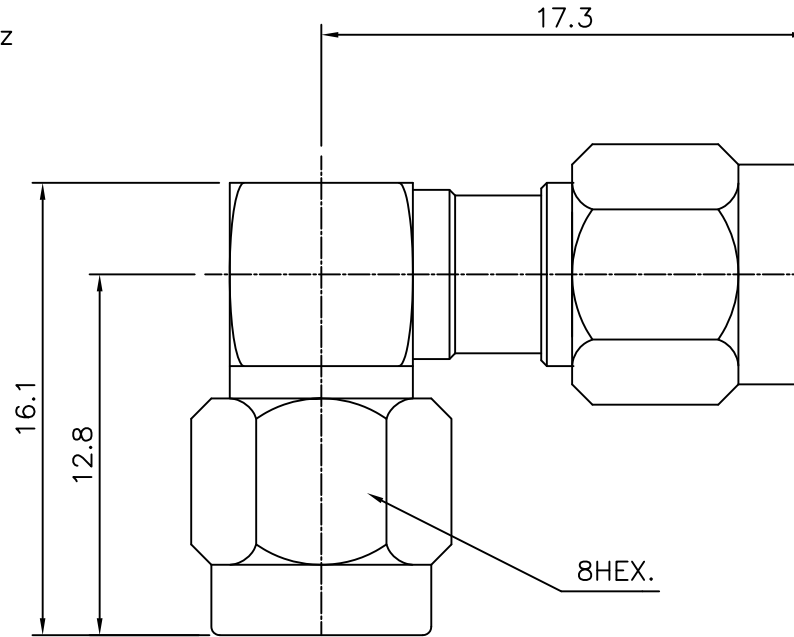

SMA Right Angle
Plug to Plug Adaptor

Connector parts	Materials	Finish
Coupling Cap	Brass	Gold plated
Body	Brass	Gold plated
Center contact	Brass	Gold plated
Insulator	PTFE	-

CUSTOMER

NO.	DESCRIPTION	Q'TY	MATERIAL	FINISH	REMARKS.
PARTS No.	SMA-806-003	NAME	SMA-R/A-PP Adap.		APPROVED
MATERIAL	FINISH	TOLERANCES OTHERWISE SPEC. ±0.05		ANGLES ±1°	CHECKED
		SCALE	UNIT mm		DESIGNED S.J.LEE
		DWG NO.	SMA-806-003		DATE. 12/JUN/2007